

 Search with **Ctrl-F** (PC) or **Command-F** (Mac) to quickly find what you're looking for.



# M2-Series Parts Manual

BN72-14-AC-Autodrive-Open Bus

# Contents

1	Chassis	3
2	Front Suspension	4
3	Rear Suspension	5
4	Steering System	7
5	Brake System	9
6	Tire Assembly	12
7	Vehicle Body / Front Windshield	13
8	Instrument Panel	14
9	Roof	16
10	Column Device	17
11	Body Rear Wall	19
12	Seat	20
13	Rear Seat	23
14	Arm Rest	24
15	Body Accessories	25
16	Electrical Parts	26
17	Optional Parts	27

# 1 Chassis

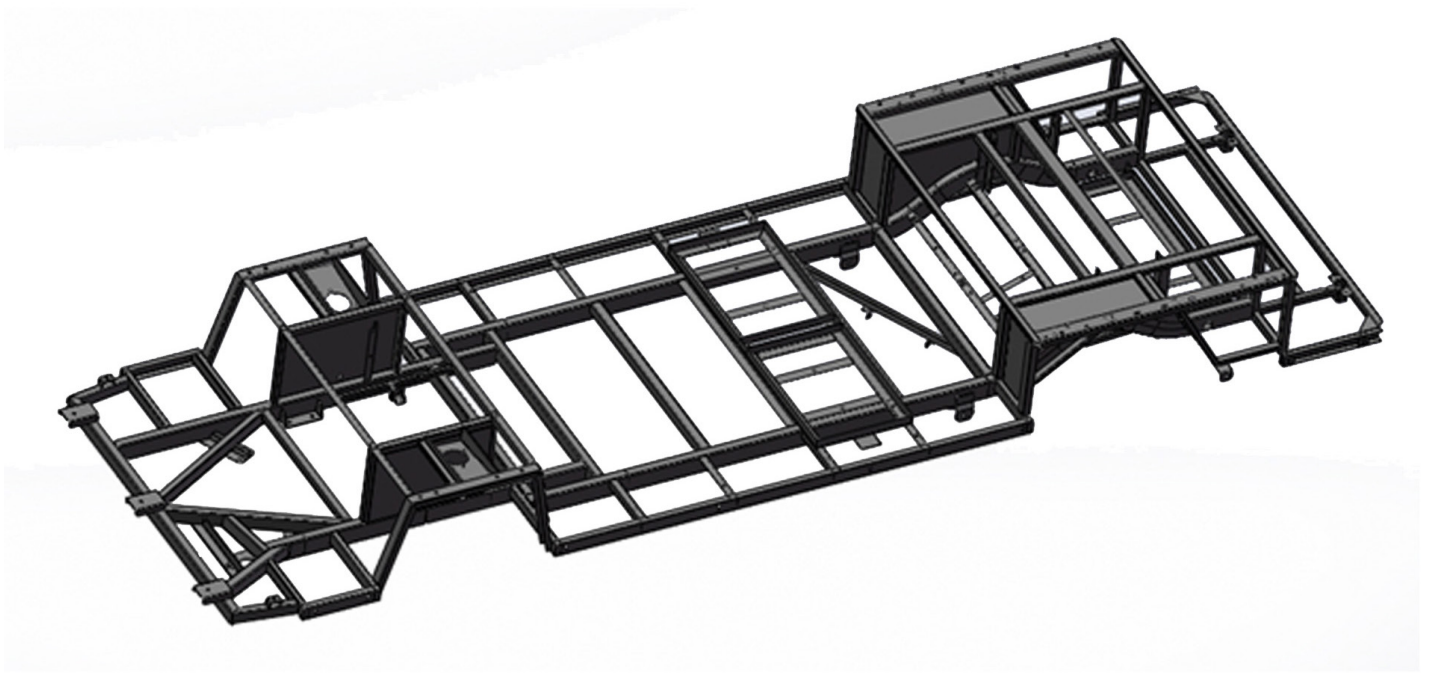

Item No.	STAR EV Part No.	Description	MPN	Qty
1-1		Chassis	2200025549S00	1

## 2 Front Suspension

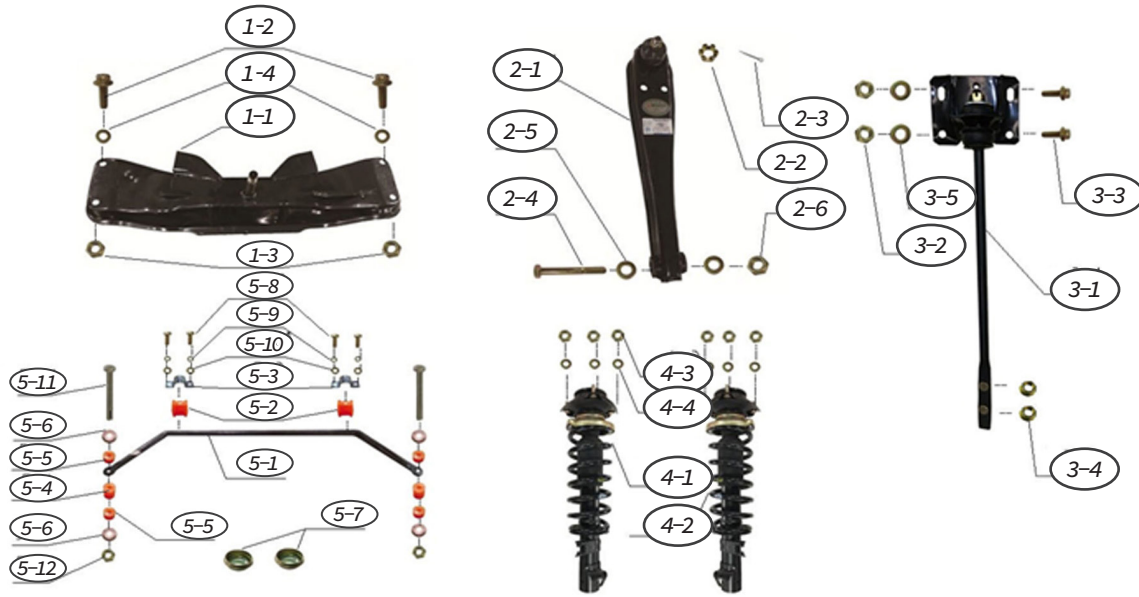

Item No.	STAR EV Part No.	Description	MPN	Qty
1		Front beam assembly and installation accessories	2902701268000	1
1-1	2SC000	Front beam assembly	2204700007000	1
1-2		Hexagon flange bolt GB/T5789, M10*25	2200102249000	4
1-3		All metal hexagon flange lock nut GB/T6187.1,M10*1.5	2200404060000	4
1-4		Flat washer GB/T97.1 ,M10 (20*10.5*2)	2500600013000	4
2		Front axle swing arm and installation accessories	2902701269000	1
2-1	2SC050	Front Control Arm assembly	2204700002000	2
2-2		Hexagon thin slotted nut GB/T9459 M12*1.25	2200403002000	2
2-3	2HD214	2.5 x 22 Cotter Pin GB/T91 2.5*22	2200900008000	2
2-4		Outer hexagon bolt GB/T5782, M10*80	2200102102000	2
2-5		Flat washer GB/T97.1 ,M10(20*10.5*2)	2500600013000	4
2-6		All metal insert lock nut GB/T6184, M10	2200450004000	2
3		Diagonal tie rod assembly and installation accessories DN-14F-1G	2902701270000	1
3-1	2SC062	Tension Rod Assembly	2204800062000	2
3-2		All metal hexagon flange lock nut GB/T6187.2 M10*1.25	2200404072000	4
3-3		Hexagon flange bolt GB/T5789, M10*25	2200102249000	4
3-4		All metal hexagon flange lock nut GB/T6187.1,M10*1.5	2200404060000	4
3-5		Flat washer GB/T97.1, M10 (20*10.5*2)	2500600013000	4
4		Front shock absorber and install accessories DN-14F-1G	2902701271000	1
4-1	2SC111	Front left / Driver shock absorber assembly	2205300111002	1
4-2	2SC121	Front right shock absorber assembly	2205300112002	1
4-3		All metal insert lock nut GB/T6184, M8	2200450003000	6
4-4		Flat washer GB/T97.1,M8 (16*8.4*1.6)	2500600012000	6
4-5		Outer hexagon bolt GB/T5783, M10*60	2200102100000	2
4-6		Flat washer GB/T97.1 ,M10(20*10.5*2)	2500600013000	4
4-7		All metal insert lock nut GB/T6184, M10	2200450004000	2
4-8		Fine pitch full thread hexagon bolt GB/T5786, M10*1.25*15	2200108002000	2

### 3 Rear Suspension

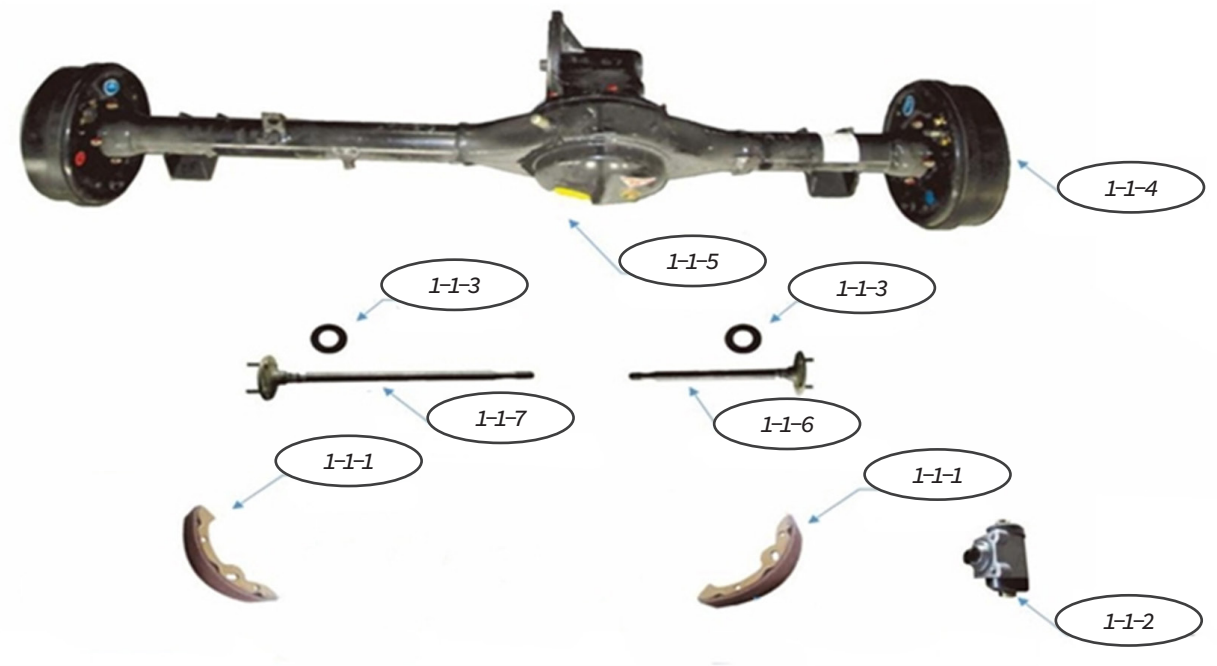
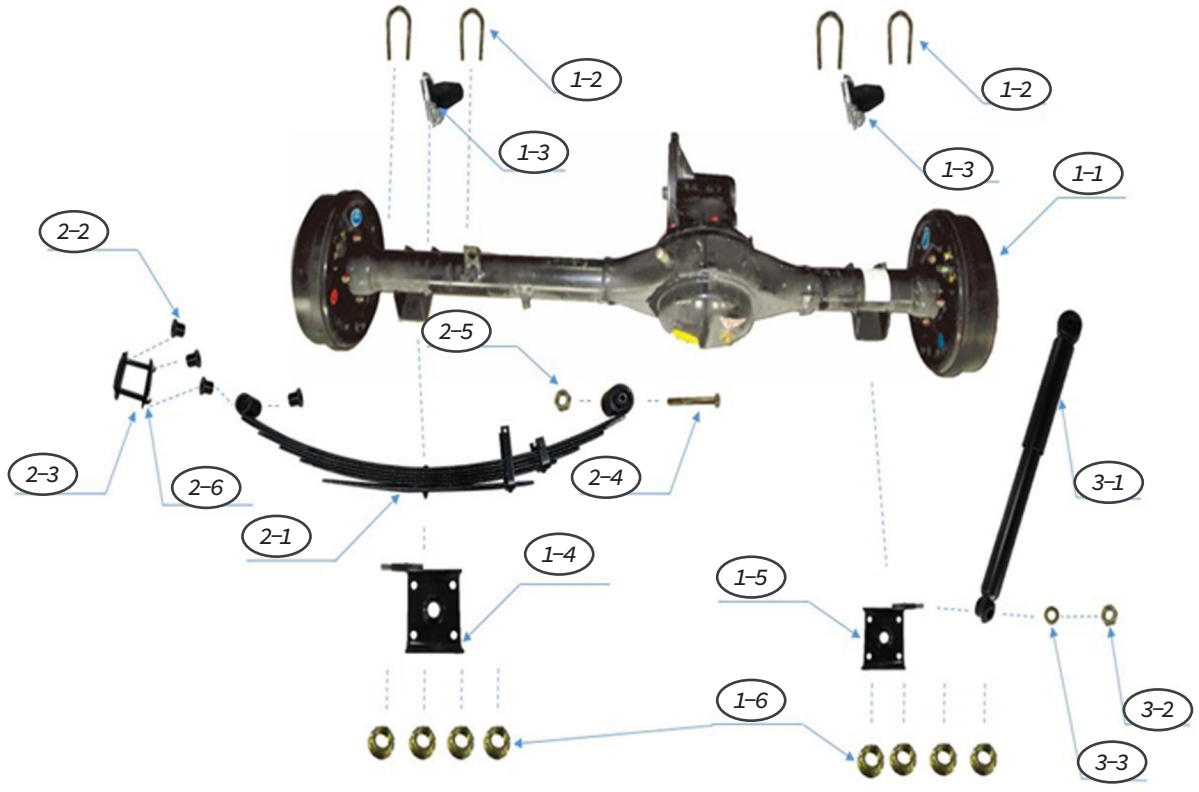

Item No.	STAR EV Part No.	Description	MPN	Qty
1		Rear axle and installation accessories	2101008770	1
1-1	2RE163	Rear axle assembly DN.14F-11040000 17.8	3105011474	1
1-1-1	2SH030	Rear brake shoe	2204500025000	4
1-1-2	2CY204	Rear Wheel cylinder with vent nozzle	2204300026000	1
1-1-3	2OL200	Halfshaft oil seal 48*62*9,SK410	2301300020000	2
1-1-4		M12*1.25 Lugnut	3600000944	1
1-1-5	2RR252	Gear Box 17.8:124 ratio	3600001461	1
1-1-6	2AX403	Passenger side half axle (Short)	3600001142	1
1-1-7	2AX402	Driver side halfshaft (Long)	3600001143	1
1-2	2LF054	U-bolt N.8-11000001 45 HRC28~32	4501000045	4
1-3	2LF053	Rear leaf spring bumper	2208605009000	2
1-4	2LF046	Rear left leaf spring seat assembly	2204010016000	1
1-5	2LF047	Rear right leaf spring seat assembly	2204010020000	1
1-6		All metal hexagon flange lock nut GB/T6187.1, M10*1.5	2200404060000	8
2		Rear leaf spring assembly	2905405046000	1
2-1	2LF060	Rear leaf spring assembly	2204010036000	2
2-2	2BS320	Rear leaf spring bushing	2301900020000	8
2-3	2LF049	Outer plate assembly of rear leaf spring	2208605010000	2
2-4		Outer hexagon bolt GB/T 5782, M12*110	2200102254000	2
2-5		All metal insert lock nut GB/T6184, M12	2200450005000	2
2-6		All metal hexagon flange lock nut GB/T6187.1,M10*1.5	2200404060000	2
3		Shock absorber and installation accessories DN-14F-1G	2902701275000	1
3-1	2SK270	Rear shock absorber assembly (DN.4A-12020000)	2205300020B03	2
3-2		All metal insert lock nut GB/T6184, M8	2200450003000	2
3-3		Extra large flat cushion GB/T5287, M8 (28*9*3), A200	2200704014000	4
3-4		All metal insert lock nut GB/T6184, M12	2200450005000	2
3-5		Flat washer GB/T97.1,M12 (24*13*2.5)	2500600014000	4

## 4 Steering System

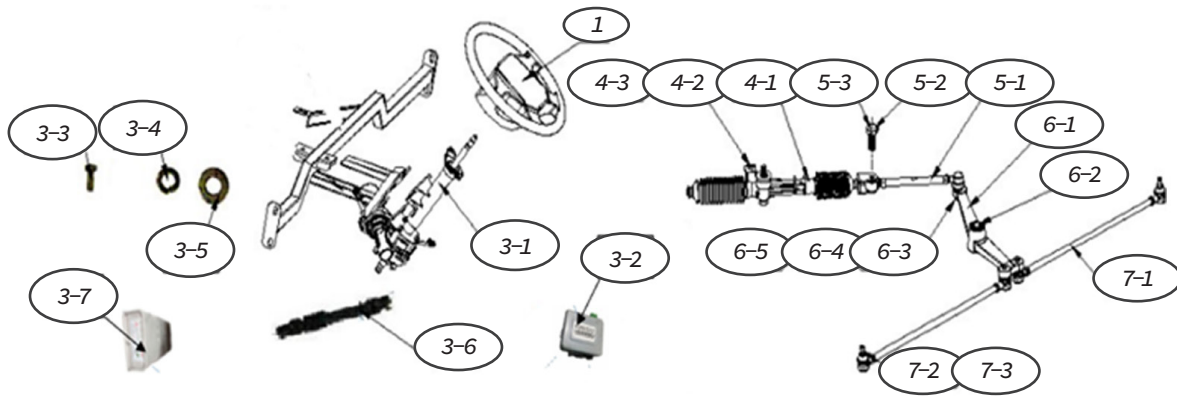

Item No.	STAR EV Part No.	Description	MPN	Qty
1	2SL061	Steering wheel assembly $\phi 3403$ m=0.45	3101050018	1
3		Steering upper shaft device DN-14G	2101005490	3
3-1	2ST911	Electric power steering upper shaft assembly 433-101C3400-00	3101020038	3-1
3-2	2ST902	Power steering controller	3203020052	3-2
3-3		Outer hexagon bolt GB/T5783, M6*20	4101010293	3-3
3-4		Spring washer GB/T93,6.1	4104020004	3-4
3-5		Flat washer GB/T97.1, M6 (12*6.4*1.6)	4104010057	3-5
3-6	2ST247	Steering lower shaft	3101030025	3-6
3-7	2CV142	DC converter for Power steering 72V-12V, DC2250-7212,50A	3202060011	3-7
4		Steering gear and installation accessories DN-14M-1	2101009049	4
4-1	2ST561	Steering gear assembly (Redirector) DN.14F.1E-0101001 215mm	3101010019	4-1
4-2		Hexagon flange bolt GB/T5789, M10*30	4101020346	4-2
4-3		Spring washer GB/T93,6.1	4104020004	4-3
5		Steering tie rod and installation accessories DN-14F-1G	2101001601	5
5-1	2ST802	DRAG LINK DN.14F.1E-01030001,A0,260,18	3101040036	5-1
5-2		Threaded rod hexagon head bolt with hole GB/T31.1 M12*50 8.8	2200101001000	5-2
5-3		Hexagon thin slotted nut with coarse thread GB/T6181-M12	4102030006	5-3
6	2ST701	Steering center rocker arm and installation accessories	2902701282000	6
6-1		Steering center rocker arm assembly	2204700093000	6-1
6-2	2BS501	Steering center rocker arm bushing	2204700100B10	6-2
6-3		Hexagon thin slotted nut GB/T9459 M18*1.5	2200403008000	6-3
6-4	2HD211	Cotter Pin 3 x 30	2200900003000	6-4
6-5		Flat washer GB/T 97.1-20	4104010110	6-5

7		Steering tie rod and installation accessories DN-14F-1G	2101001603	7
7-1	2TI301	Steering tie rod assembly SH,HFJ3003200CA L=410MM	3101040057	7-1
7-2		Hexagon thin slotted nut GB/T9459 M12*1.25	2200403002000	7-2
7-3	2HD211	Cotter Pin 3 x 30	2200900003000	7-3



## 5 Brake System

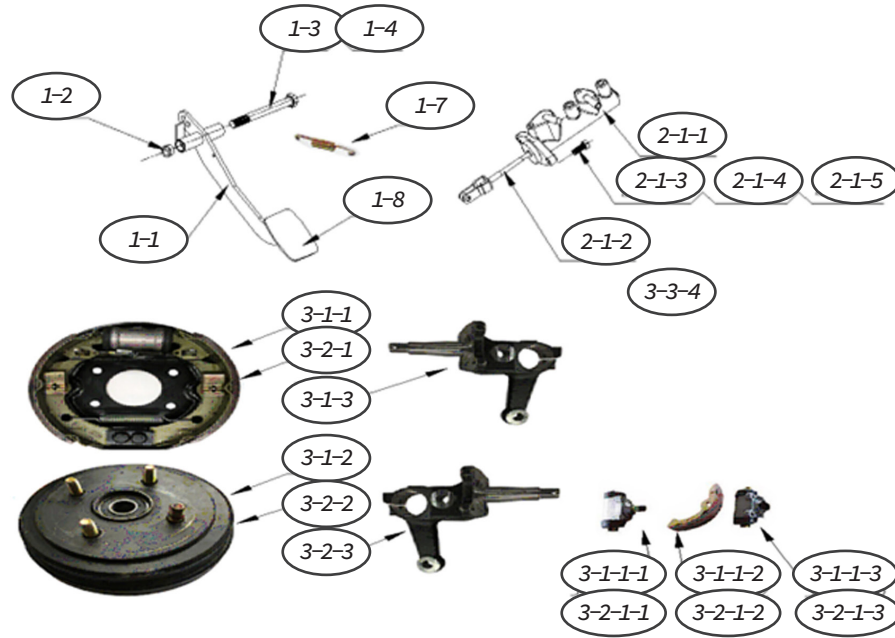

Item No.	STAR EV Part No.	Description	MPN	Qty
1	2PD122	Brake pedal device and installation accessories	2905408010000	1
1-1		brake pedal DN.14G-03040020(A0)	2206200267A00	1
1-2	2PD123	Copper sleeve DN.14F-03030303,HPb59-1 ( $\phi 18 \times \phi 14 \times \phi 12.2 \times 12$ )	2202100229B00	2
1-3		Non metal insert hexagon lock nut GB/T6184, M12	2200450005000	1
1-4		Flat washer GB/T97.1,M12(24*13*2.5)	2500600014000	1
1-5	2HD202	8 x 22 CLEVIS PIN GB/T882,8*22,B	2200902007000	1
1-6	2HD214	2.5 x 22 Cotter Pin GB/T91 2.5*22	2200900008000	1
1-7	2PD124	Extension spring 110mm	6200202005A00	1
1-8	2PD125	Brake pedal sheath STOP,78*88*10.6	2301900005000	1
2-1		Brake pump unit	2900500161000	1
2-1-1	2MC050	brake master cylinder 7/8", 80mm	2206300005000	1
2-1-2	2MC040	Brake master cylinder adjustable push rod 95mm	2204900027000	1
2-1-3	#N/A	Hexagon nut GB/T6170,M8	2200400145000	2
2-1-4	2HD203	$\phi 8 \times 28$ CLEVIS PIN GB/T882-2008	2200902082000	2
2-1-5	3HD869	Flat Washer GB/T97.1, M8 (16*8.4*1.6)	2500600012000	2
2-1-6	2HD214	2.5 x 22 Cotter Pin GB/T91 2.5*22	2200900008000	1
	2PD773	Hydraulic pump push rod $\phi 9 \times 85, 45$	2204900183000	1
	2PD769	Brake pedal hydraulic connector	2204900181000	1
		Outer hexagon bolt GB/T5783, M8*30	2200102129000	2
		M8 Flat washer : GB/T97.1,M8(16*8.4*1.6)	2500600012000	2
		All metal insert lock nut GB/T6184, M8	2200450003000	2
3		Front brake hub assembly	2902701285000	1
3-1		Hub brake assembly	2902701286000	1
3-1-1	2BP815	Front Driver Side Backing Plate Assembly HX800, 220 220014	2205500132000	1

3-1-1-1	2CY350	Front Driver wheel cylinder with bleeder valve 6350	2204300003000	1
3-1-1-2	2SH005	FRONT Brake shoe, 2205.25mm	2204500008000	4
3-1-1-3	2CY352	Front Driver wheel cylinder with OUT bleeder valve 6350	2204300008000	1
3-1-2	2DR015	Front hub $\phi$ 114.3 6350 220014	2205201014000	2
3-1-3	2SP232	Left steering knuckle 46*68 220014	2205400036000	1
3-2-1	2BP816	Front Passenger Side Backing Plate Assembly HX800 , 220,220014	2205500134000	1
3-2-1-1	2CY351	Front passenger wheel cylinder with bleeder valve 6350	2204300004000	1
3-2-1-2	2SH005	FRONT Brake shoe, 220, 5.25mm	2204500008000	4
3-2-1-3	2CY353	Front passenger wheel cylinder without bleeder valve, 6350	2204300009000	1
3-2-2	2DR015	Front hub $\phi$ 114.3, 6350 220014	2205201014000	2
3-2-3	2SP233	Passenger side steering knuckle 46*68 220014	2205400037000	1

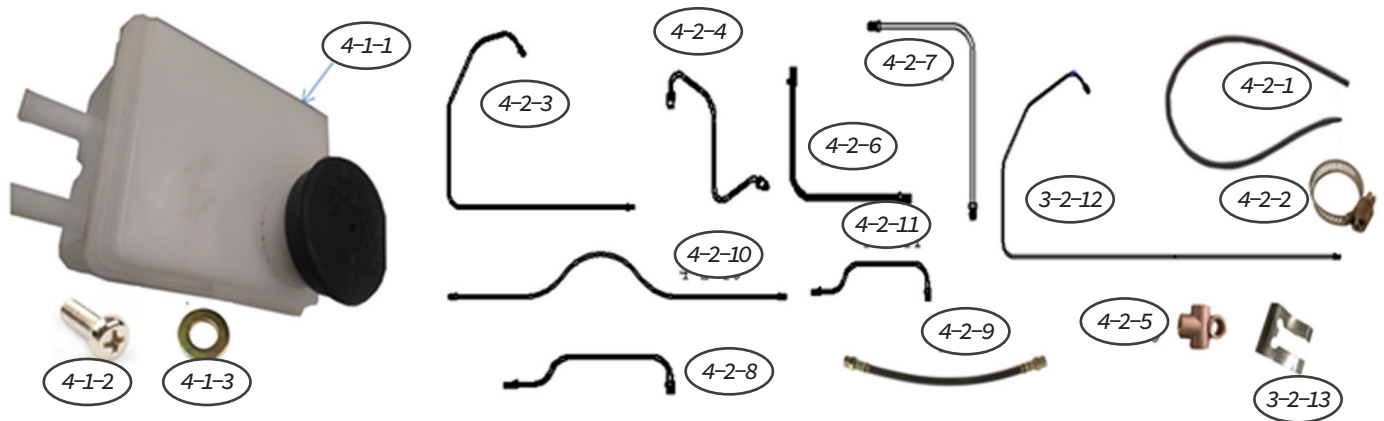

Item No.	STAR EV Part No.	Description	MPN	Qty
4		Brake oil pipe components DN-14G	2902701445000	1
4-1		Brake oil pot and installation accessories DN-14G	2905410005000	1
4-1-1	2TB030	Brake fluid tank (Reservoir ) DN.4A-03030066, PVC	2303300013A00	1
4-1-2		Cross recessed pan head screws GB/T818, M6*16	2200304205000	2
4-1-3		Flat washer GB/T97.1,M6(12*6.4*1.6)	2500600011000	2
4-2		Brake oil pipe connection assembly DN-14G	2902701289000	1
4-2-1	2TB029	TUBE $\Phi$ 15* $\Phi$ 8.5 for Brake Reservoir	2300500002000	2
4-2-2	2TB028	Clamp	2207901008000	4
4-2-3	2TB171	1800mm Brake oil pipe 1 DN.14F-03060001, $\Phi$ 4.76PVF M10*1, 10mm	2206700072B00	1
4-2-4	2TB191	400mm Brake oil pipe 3 DN.14F-03060003, $\Phi$ 4.76PVF M10*1, 10mm	2206700074B00	1
4-2-5	2TB242	3-way valve M10*1, 8mm	2201706001000	1
4-2-6	2TB201	400mm Brake oil pipe 4 DN.14F-03060004, $\Phi$ 4.76PVF M10*1 10mm	2206700075B00	1
4-2-7	2TB211	350mm Brake oil pipe 5 DN.14F-03060005, $\Phi$ 4.76PVF M10*1, 10mm	2206700076B00	1
4-2-8	2TB221	Brake oil pipe 6 DN.14F-03060006, $\Phi$ 4.76PVF M10*1, 10mm	2206700077B00	1

4-2-9	2TB001	35cm Flexible Tube Φ11, 3.2	2206700034B00	3
4-2-10	2TB181	1200mm Brake oil pipe 8 DN.14F-03060008,Φ4.76PVF M10*1, 10mm	2206700079B00	1
4-2-11	2TB182	300mm Brake oil pipe 9 DN.14F-03060009,Φ4.76PVF M10*1, 10mm	2206700080B00	1
4-2-12	2TB183	4600mm Brake oil pipe (middle) DN.14F.1G-03060002,Φ4.76PVF M10*1, 10mm,	2206700159A00	1
4-2-13	2CB083	E-type snap ring Q/2A-CJ-425	2207901006000	7

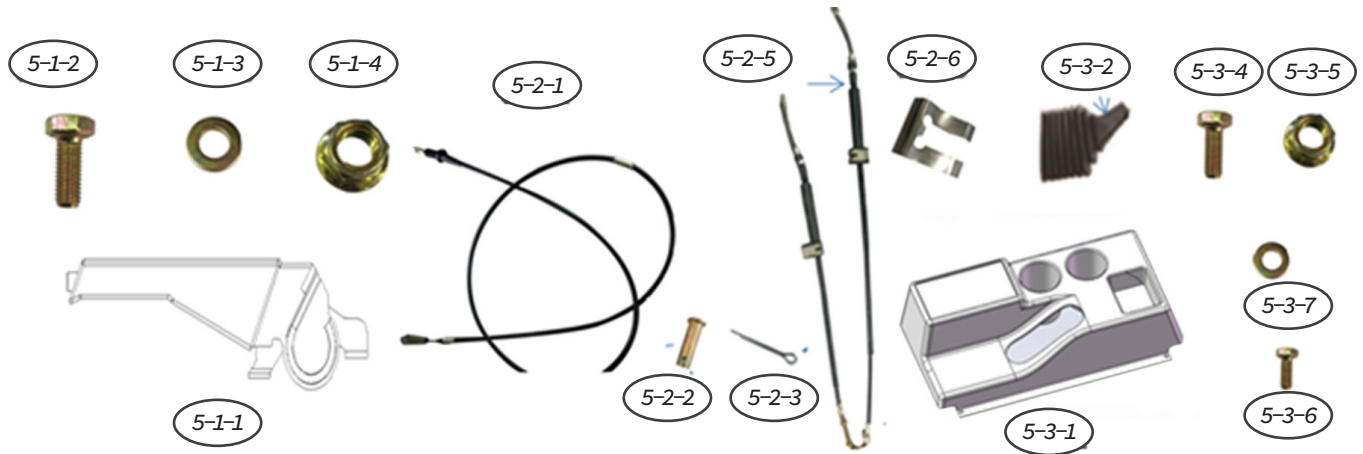

Item No.	STAR EV Part No.	Description	MPN	Qty
5		Parking brake	2905409007000	1
5-1		Parking handle and installation accessories	2905411005000	1
5-1-1	2PB802	Handbrake handle	2209700001000	1
5-1-2		Hexagon headed bolt GB/T5783, M8*30	2200102129000	2
5-1-3		Flat washer GB/T97.1,M8 (16*8.4*1.6)	2500600012000	2
5-1-4		Non metal insert hexagon lock nut GB/T6184, M8	2200450003000	2
5-2		Parking cable and installation accessories, DN-14G	2905412005000	1
5-2-1	2CB049	Parking brake main cable #1, L=2750mm	2200002076S00	1
5-2-2	2HD200	Clevis Pin 8 x 20 GB/T882	2200902002000	1
5-2-3	2HD211	Cotter Pin 3 x 30 GB/T91	2200900003000	1
5-2-4	2CB051	Rear parking brake cable #2 DN.14F-03040000	2206901002B00	1
5-2-5		Outer hexagon bolt GB/T5783, M6*15	2200102246000	2
5-2-6	2CB083	E-type snap ring Q/2A-CJ-425	2207901006000	1
5-3		Parking handle cover and installation accessories DN-14G	2905413003000	1
5-3-1	2PB141	Hand brake trim cover (with skin)	2401201220000	1
5-3-2	2PB804	Boot for Handbrake HS14	2401201214000	1
5-3-3		Outer hexagon bolt GB/T5783, M5*20, A2-70	2200102148000	4
5-3-4		Hexagon nut GB/T6170,M5, A2-70	2200400149000	4
5-3-5		Cross recessed pan head tapping screws GB/T845, ST4.8*25, A2-70	2200500233000	4
5-3-6		Large flat washer GB/T96, M5 (15*5.3*1), A200	2301908145000	8

## 6 Tire Assembly



Item No.	STAR EV Part No.	Description	MPN	Qty
1-1	2TR261	165/70 R 13 DEWSTONE WR080-02 for M-Series	2301400014001	4
1-3	2VL900	Valve stem	2205900006000	1
1-4	2LN015	Wheel nut Q/2A-CJ-159-M12*1.25	2200406043000	8
2	7RM960	Tire assembly	2903700235000	4
2-1	2TR261	165/70 R 13 DEWSTONE WR080-02 for M-Series	2301400014001	4
2-2	2RM906	Aluminum rim 13 x 5.00B, 4H x 114.3, ET = 27	2205100002000	1
2-3	2VL900	Valve stem	2205900006000	1
2-4	2LN015	Wheel nut Q/2A-CJ-159-M12*1.25	2200406043000	8

## 7 Vehicle Body / Front Windshield

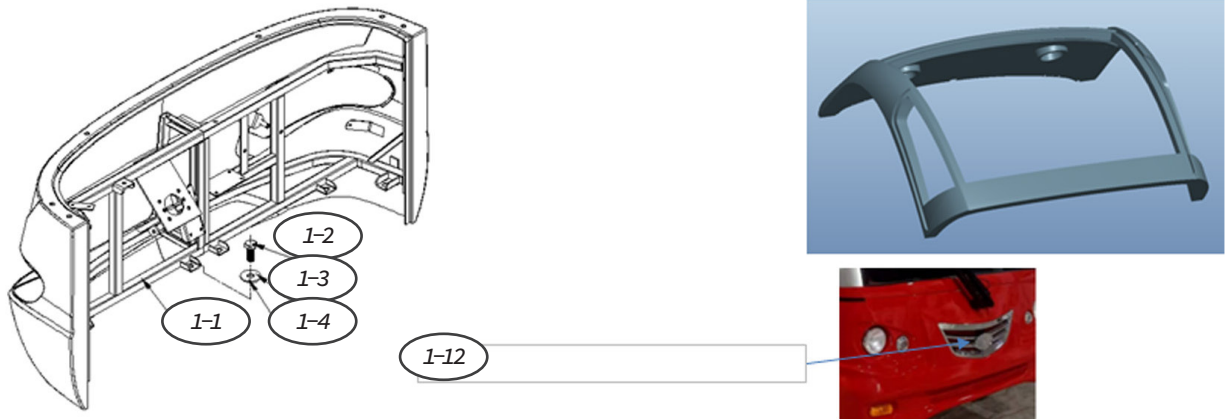

Item No.	STAR EV Part No.	Description	MPN	Qty
1-1	2BO450	Front Body	2400100460A00	1
1-2	2WP078	Wiper holder DN.4A-05000022	2205000141B00	3
1-3		Outer hexagon bolt GB/T5783, M8*30	2200102128000	3
1-4		M8 Flat washer :GB/T97.1,M8(16*8.4*1.6)	2500600012000	3
1-5		M8 Spring washer :GB/T93,8.1,	2200701086000	3
1-8	2RP450	Open flat circle cap self-plugging rivet 5*20 GB/T12618 5*20 A2-70	2201000001000	
1-9		Outer hexagon bolt GB/T5783, M10*20	2200102096000	
1-10		Flat washer GB/T97.1 ,M10 (20*10.5*2)	2500600013000	
1-11		M10 Spring washer GB/T93, 10.2,	2200701087000	
1-12	2BO452	Grill - Front Body, ZH0163	2301000001000	1
2-1	2WS476	Sheet metal front windshield assembly DN.14F.9-20005000, (A0)	2400100698000	1
2-2	2WH314	Connecting line (power supply) DN.14F-14010010, B1, UL2464-20#*2C	3205022452	1
2-3		Hexagon nut GB/T6170, M16*1.5	2200400175000	2
2-4		Extra large flat cushion GB/T5287, M10 (34*11*3)	2200704008000	2
2-5		Hexagon headed bolt B/T5783,M8*25	2200100467000	3
2-6		Large flat washer GB/T96, M8 (24*8.4*2)	2200704006000	6
2-7		All metal insert lock nut GB/T6184, M8	2200450003000	3
2-8	2RD065	Speaker cover φ152 3215080001	3406009304	2
2-9		M2 x 25 Cross recessed countersunk head self drilling self tapping screw GB/T15856.2 ST4	2200300068000	8

## 8 Instrument Panel

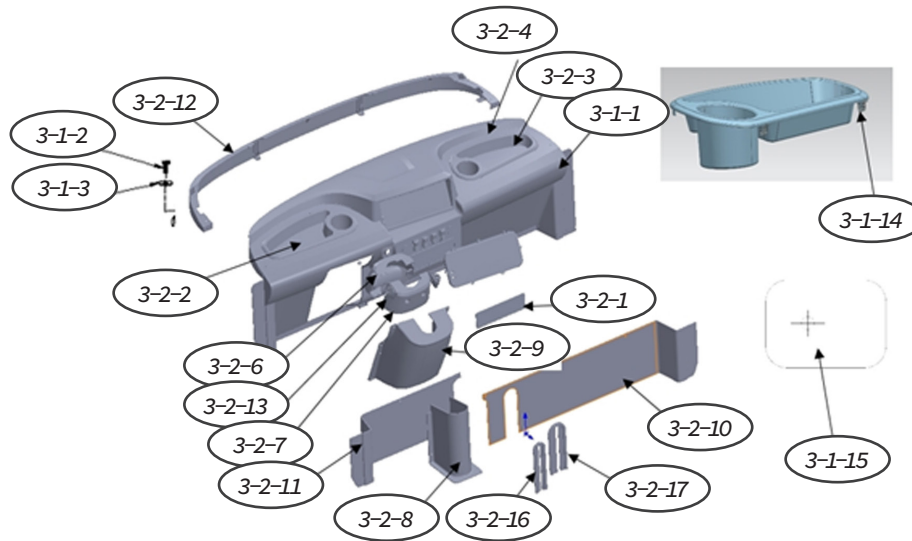

Item No.	STAR EV Part No.	Description	MPN	Qty
3-1		Instrument panel and installation accessories	2905442024000	1
3-1-1	2DB650	Dashboard DN.14G.1-20060400,PP	2301600082000	1
3-1-2		Cross recessed pan head screws GB/T818, M3*16 A2-70	2200304206000	3
3-1-3		Flat washer GB/T97.M4(9*4.3*0.8)	2500600009000	3
3-2		Accessories of lower dashboard DN-14F-9	2905526006000	1
3-2-1	2DB651	CD player COVER on lower dashboard DN.14G.1-20060520,PP	2207302189000	1
3-2-2	2DB652	Driver Side STORAGE BOX on Dashboard DN.14G.1-20060451,PP	2401016022000	1
3-2-3	2DB653	Passenger Side STORAGE BOX on Dashboard DN.14G.1-20060452,PP	2401016023000	1
3-2-4	2DB655	TRIM for Passenger Side STORAGE BOX on Dashboard DN.14G.1-20060422	2300400675000	1
3-2-5	2DB654	TRIM for Driver Side STORAGE BOX on Dashboard DN.14G.1-20060421	2300400676000	1
3-2-6	2DB656	Upper Cover for Combination Switch on Dashboard DN.14G.1-20060470,PP	2300800179000	1
3-2-7	2DB657	Lower Cover for Combination Switch on Dashboard DN.14G.1-20060480,PP	2300800180000	1
3-2-8	2DB658	Instrument panel direction hood DN.14G.1-20060510,PP	2300800181000	1
3-2-9	2DB659	Instrument panel steering column cover plate DN.14G.1-20060490,PP	2401026006000	1
3-2-10	2DB660	Right lower baffle of instrument panel DN.14G.1-20060440,PP	2401018309000	1
3-2-11	2DB661	Left lower baffle of instrument panel DN.14G.1-20060430,PP	2401018310000	1

3-2-12	2DB662	Instrument panel support frame DN.14G.1-20060410,ABS	2207202562000	1
3-2-13	2DB663	Lower tube of instrument panel 20*20*2/Q235 DN.14G.1-20060414(A0)	2301900201000	2
3-2-14	2DB664	Storage box clip 300	2202001068000	10
3-2-15	2DB665	Instrument retainer plate DN.14G.1-28000261T=2mm/304#	2207302204000	2
3-2-16	2DB666	Brake pedal cover DN.14G.1-18130003, A1, 0.8mm	2207302300000	1
3-2-17	2DB667	Accelerator pedal cover DN.14G.1-18130002, A1, 0.8mm	2207302301000	1

## 9 Roof

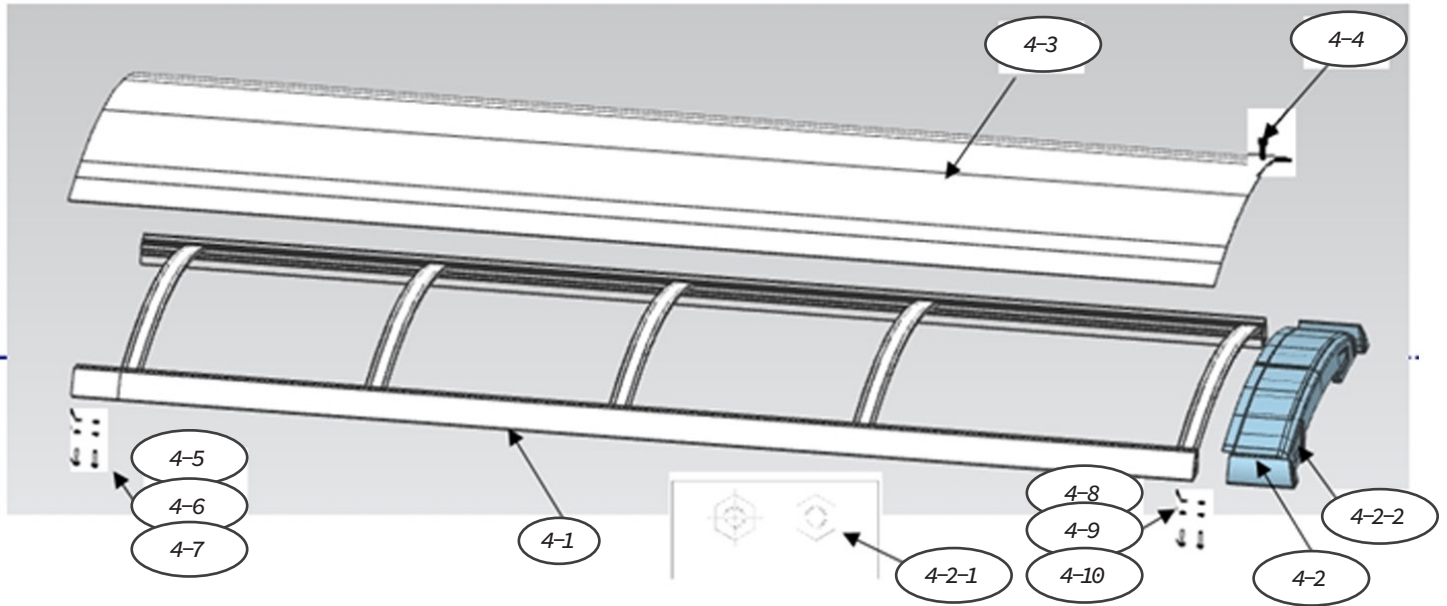

Item No.	STAR EV Part No.	Description	MPN	Qty
4-1	2RF453	Roof device and installation accessories	2905451056000	4-1
4-1	2RF454	Roof frame DN.14G.1-05040400	2207202525000	4-1
4-2	2RF455	Ceiling tail edge DN.14G.1-05040300, PP	2400300356000	4-2
4-2-1	2RF456	Tail edge mounting plate DN.14G.1-05040321 (A0) Q235	2400300357000	4-2-1
4-2-2	2DC107	DN-14G rear reflector (left and right) 174.9*43.8mm, 3M,983-72,	2500909109000	4-2-2
4-3	2RF457	Ceiling glass sheet DN.14G.1-23000020 (A0) 3346*1360*3.0	2207302126000	4-3
4-4		Cross recessed pan head tapping screws GB/T845, ST4.2*25, A2-70	2200500248000	4-4
4-5		Outer hexagon bolt GB/T5783, M10*35, A2-70	2200102208000	4-5
4-6		Flat washer GB/T97.1, M10(20*10.5*2), A200	2500600019000	4-6
4-7		Spring washer GB/T93,10.2	2200701093000	4-7
4-8		Outer hexagon bolt GB/T5782, M8*35,A2-70,	2200102216000	4-8
4-9		Flat washer GB/T97.1, M10 (20*10.5*2	2500600019000	4-9
4-10		Spring washer GB/T93,8.1	2200701092000	4-10



## 10 Column Device

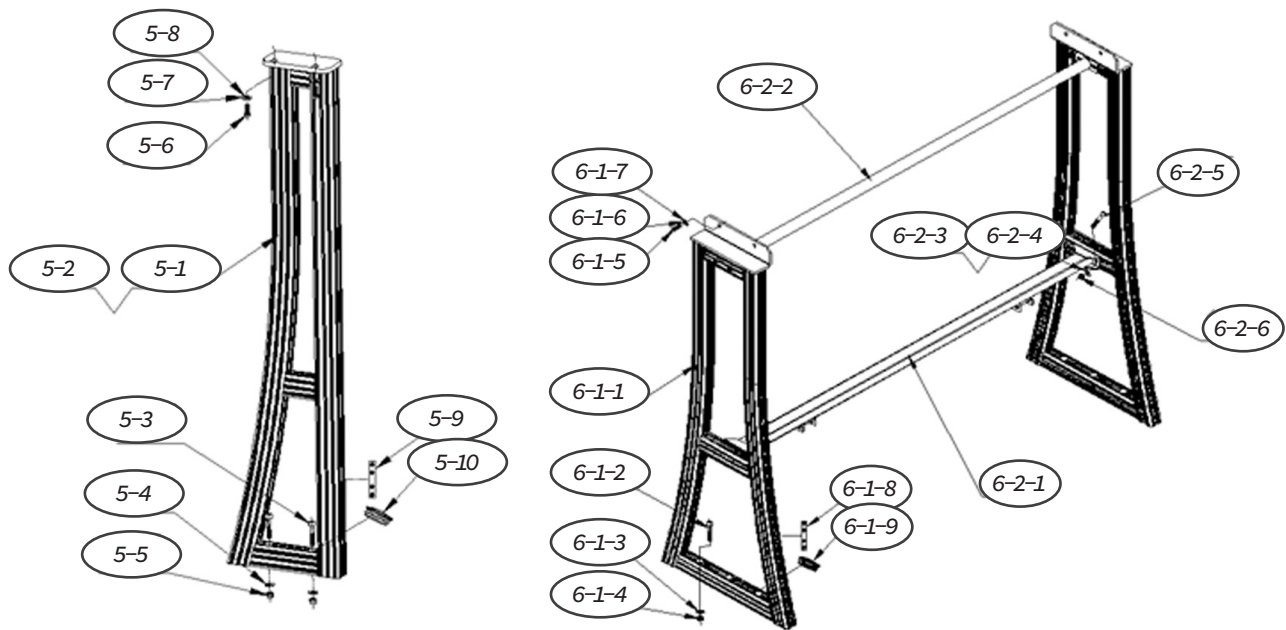

Item No.	STAR EV Part No.	Description	MPN	Qty
5-1	2BK650	B pillar (left) DN.14G-25010110 (A/1) 6063-T5	2208300180010	1
5-2	2BK651	B pillar (right) DN.14G-25010120 (A1), 6063-T5	2208300182010	1
5-3		Hexagon socket flat round head screws GB/T 70.2M8*45, A2-70	2200413060000	4
5-4		Large flat washer GB/T96, M8 (24*8.4*2,A200)	2200704006000	4
5-5		Non metal insert hexagon lock nut GB/T889.1, M8,A2-70	2200401052000	4
5-6		Outer hexagon bolt GB/T5783, M8*20, A2-70	2200102135000	4
5-7		M8 Spring washer GB/T93,8.1	2200701092000	4
5-8		Flat washer GB/T97.1, M8(16*8.4*1.6), A200	2500600018000	4
5-9		Armrest strip nut DN.14G-25010206(A0), T=6/Q235	2200413001000	4
5-10	2RP780	Plastic Plug DG.C2.8-05000090	2301906067000	4
6-1		C-column support frame and installation accessories DN-14G	2904400965000	1
6-1-1		C-column DN.14G-25010200(A/1) /Q235	2208300184010	2
6-1-2	2BK652	Hexagon socket flat round head screws GB/T70.1 M8*45, A2-70	2200413060000	6
6-1-3		Large flat washer GB/T96, 8, A200	2200704006000	6
6-1-4		Non metal insert hexagon lock nut GB/T96, 8, A200	2200401052000	6
6-1-5		Outer hexagon bolt GB/T5783 M8*20 A2-70	2200102135000	10
6-1-6		Spring washer GB/T93,8	2200701092000	10
6-1-7		Flat Washer GB/T97.2,8,A200	2500600018000	10
6-1-8		C-column strip nut DN.14G-25010206(A0)	2200413003000	4
6-1-9		Plastic Plug DG.C2.8-05000090	2301906067000	4
6-1-10	2RP780	Armrest strip nut DN.14G-25010206(A0), T=6/Q235	2200413001000	4

6-2		C-column connecting pipe and installation accessories DN-14G-1	2904400962000	1
6-2-1		C-column horizontal middle horizontal tube assembly DN.14G.1-25020300(A0) /Q235	2208400750000	1
6-2-2	2BK653	C-column connecting pipe DN.14G-25010500(A0), Q235	2208400647000	4
6-2-3	2BK654	M8 Spring washer :GB/T93,8.1	2200701092000	4
6-2-4		M8 Flat washer GB/T97.1, M8(16*8.4*1.6) A200	2500600018000	4
6-2-5		M8 Spring washer :GB/T93,8.1	2200701092000	8
6-2-6		Spring washer GB/T93,8.1	2200402019000	8
6-2-7		M8 Spring washer :GB/T93,8.1	2200701092000	8

# 11 Body Rear Wall

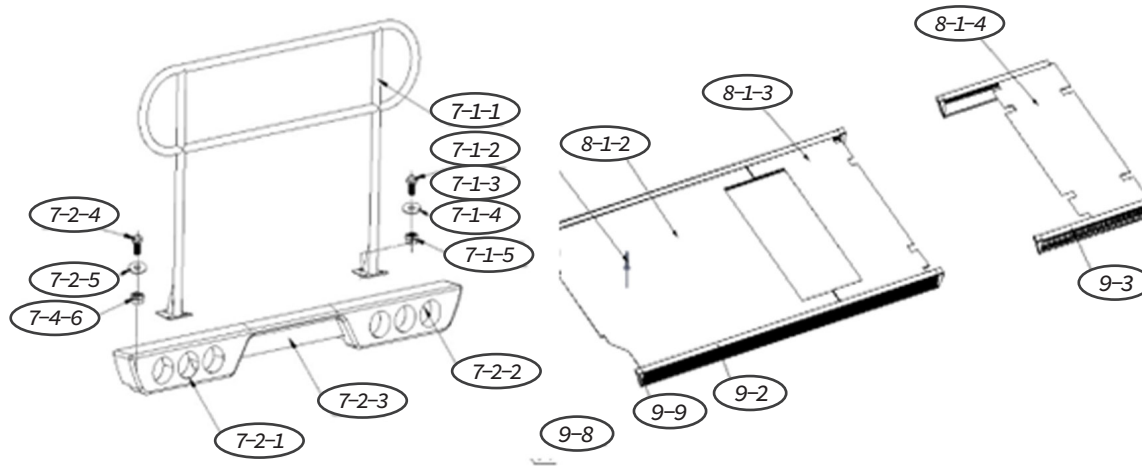

Item No.	STAR EV Part No.	Description	MPN	Qty
7-1		Rear armrest device and installation accessories DN-14G	2905453007000	1
7-1-1	2FP012	Safety Handrail - Rear Handle assembly DN.14G-28090050 (A0)	2202600269A00	1
7-1-2		Outer hexagon bolt GB/T5783, M10*60, A2-70	2200102108000	2
7-1-3		Outer hexagon bolt GB/T5783, M10*30, A2-70	2200102105000	4
7-1-4		Flat washer GB/T97.1, M10 (20*10.5*2), A200	2500600019000	6
7-1-5		M10 Hexagon lock nut w/non-metallic insert GB/T889.1, M10,A2-70	2200401053000	6
7-2		Rear bumper and installation accessories DN-14G-1	2905454026000	1
7-2-1	2BR581	Bumper-Rear DRIVER side DN.14G.1-22020020(A0)	2206400075000	1
7-2-2	2BR582	Bumper-Rear PASSENGER side DN.14G.1-22020030 (A0),PP	2206400076000	1
7-2-3	2BR583	Bumper - Rear MIDDLE section DN.14G.1-22020040(A0), 6063-T5,	2301800064000	1
7-2-4		Hexagon socket flat round head screws GB/T 70.2 M8*45, A2-70	2200413060000	2
7-2-5		Flat Washer GB/T97.1, M8(16*8.4*1.6), A200	2500600018000	4
7-2-6		Non metal insert hexagon lock nut GB/T889.1M8,A2-70	2200401052000	2
8-1		Aluminum pattern floor assembly DN-14F-9	2902701849000	1
8-1-1	2FM811	DN-14F-9, aluminum pattern floor DN.14F.9-18010010 (A0)	2300409071000	1
8-1-2	2RP450	Open flat circle cap self-plugging rivet 5*20 GB/T12618 5*20 A2-70	2201000001000	24
9-1		Side front guardrail	2205800113000	2
9-2		Side middle guardrail	2205800114000	2
9-3		Side rear guardrail	2205800115000	2
9-4		Fence edging	2208200324000	10
9-5		Outer hexagon bolt GB/T5783, M6*30, A2-70	2200102158000	10
9-6		Flat washer GB/T97.1, M6 (12*6.4*1.6), A200	2500600017000	10
9-7		Non metal insert hexagon lock nut GB/T889.1, M6,A2-70	2200401054000	10
9-8		Open end blind rivets with break pull mandrel and protruding head GB/T12618 5*25 A2-70	2201000006000	30
9-9		Side guardrail end cover (DRIVER) DN.14G 18130017(A0)	2300806276A00	4
9-10		Side guardrail end cover (PASSENGER) DN.14G-18130018(A0)	2300806277A00	4

## 12 Seat

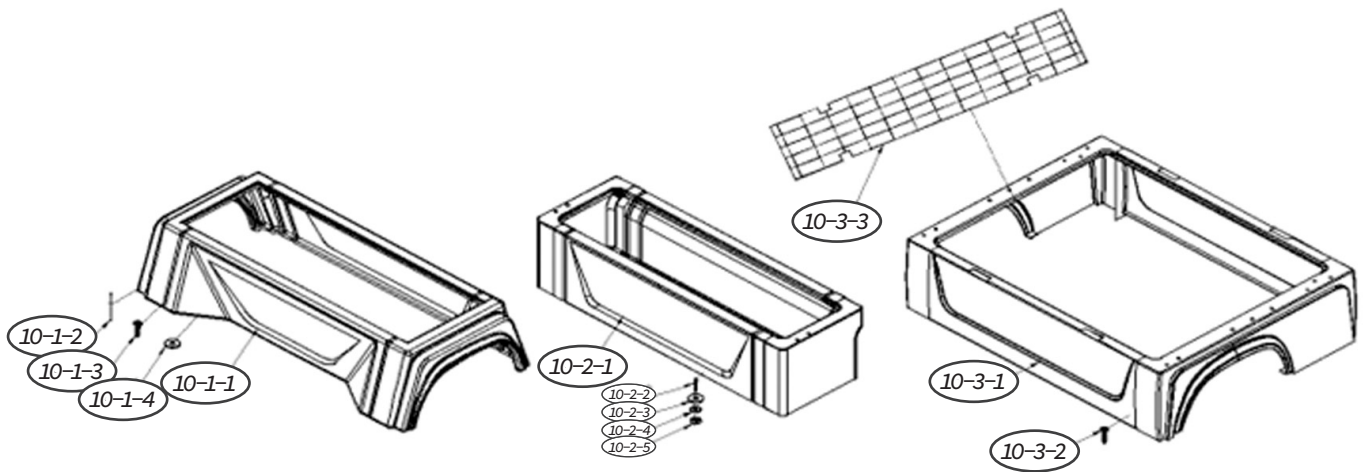

Item No.	STAR EV Part No.	Description	MPN	Qty
10-1		Seat and mounting accessories Cab seat assembly DN-14G-1	2903200865000	1
10-1-1	2PS450	Driver Seat Assembly (Pod) - DN.14G.1-28000210 (A0)	2400500820000	1
10-1-2		Cross recessed pan head tapping screws GB/T845 ST4.8*25, A2-70	2200500233000	2
10-1-3		Flat washer GB/T97.1, M5(10*5.3*1), A200	2500600016000	2
10-2	2PS451	MIDDLE row (2nd or 3rd) Seat Assembly (Pod) DN-14G-1	2903200866000	2
10-2-1		Middle row injection molding seat barrel DN.14G.1-28000230 (A0)	2400500821000	1
10-2-2		Cross recessed pan head tapping screws GB/T845 ST4.8*25, A2-70	2200500233000	8
10-2-3		Flat washer GB/T97.1 M5(10*5.3*1), A200	2500600016000	8
10-2-4		Middle seat bucket limit strip DN.14G.1-01032000,A0) T=2.0mm	2303800030000	2
10-2-5		Open end blind rivets with break pull mandrel and protruding head GB/T12618 5*16	2201000004000	4
10-3	2PS452	Back row (4th) Seat Assembly DN-14G-1	2903200867000	1
10-3-1		Rear injection seat bucket DN.14G.1-28000220,PP	2903200868000	1
10-3-2		Cross recessed pan head tapping screws GB/T845 ST4.8*25, A2-70	2200500233000	12
10-3-3	2PS453	Rear seat bucket cover A	2300407260000	2
10-3-4	2PS454	Rear seat bucket cover B	2300407261000	1

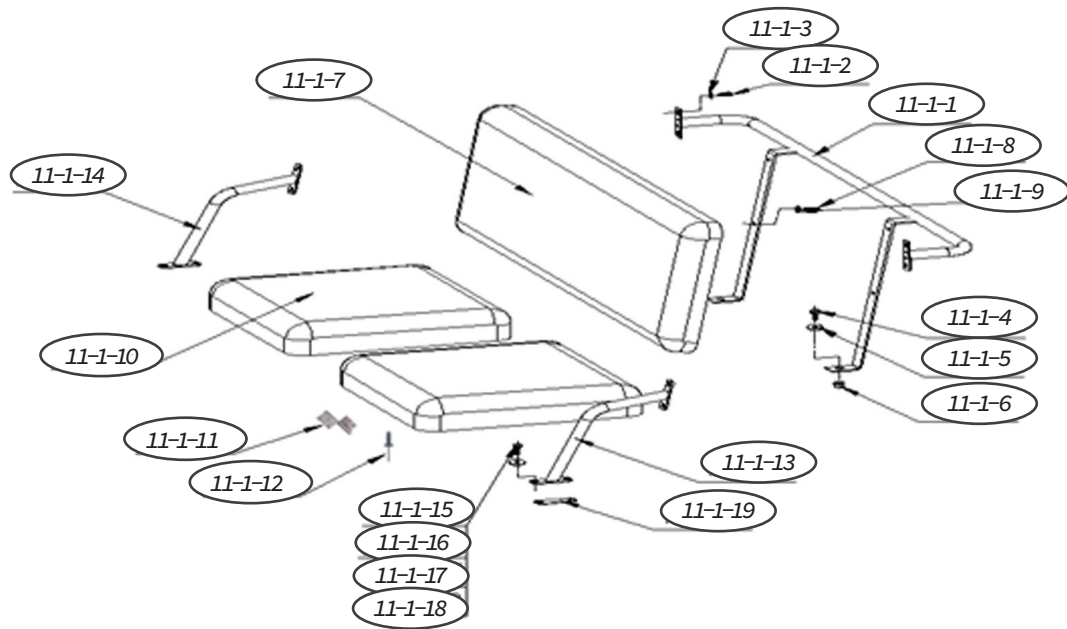

Item No.	STAR EV Part No.	Description	MPN	Qty
11-1		Driver's seat and installation accessories	2101008775	1
11-1-1	2CS421	HANDRAIL - BEHIND Driver seat	2205002059010	1
11-1-2		Hexagon socket flat round head screws GB/T 70.2M8*45, A2-70	2200413060000	4
11-1-3		M8 Spring washer : GB/T93,8.1	2200701092000	4
11-1-4		Cross recessed countersunk head bolt GB819-85, M8*30	2200107028000	2
11-1-5		M8 Flat washer GB/T97.1, M8(16*8.4*1.6), A200	2500600018000	2
11-1-6		M8 Hexagon lock nut with non-metallic insert GB/T889.1, M8,A2-70	2200401052000	2
11-1-7	2CS424	Drivers seat Backrest cushion assembly DN.14F.1D-27000500S	3108021874	1
11-1-8		Outer hexagon bolt GB/T5783, M6*45, A2-70	2200102211000	4
11-1-9		M6 washer GB/T97.1, M6(12*6.4*1.6), A200	2500600017000	4
11-1-10	2CS425	Driver seat bottom cushion Seat ASSY DN.14F.1D- 27000300S	3108021872	2
11-1-11	2HG040	Hinge DN.14F.1D-27000300S	2202200001000	4
11-1-12	2RP450	Open flat circle cap self-plugging rivet 5*20 GB/T12618 5*20 A2-70	2201000001000	12
11-1-13 11-1-14	2CS422	Driver's seat armrest DN.14G-27090010S	2202600350000	2
11-1-15		Hexagon socket flat round head screws GB/T 70.2, M8*45, A2-70	2200413060000	4
11-1-16		Spring washer GB/T93,8.1	2200701092000	4
11-1-17		Flat washer GB/T97.1, M8(16*8.4*1.6), A200	2500600018000	4
11-1-18		Non metal insert hexagon lock nut GB/T889.1, M8,A2- 70	2200401052000	2
11-1-19	2CS423	Armrest rubber pad DN.14F-04010303 1mm, 0.3mm	2301903097B00	4

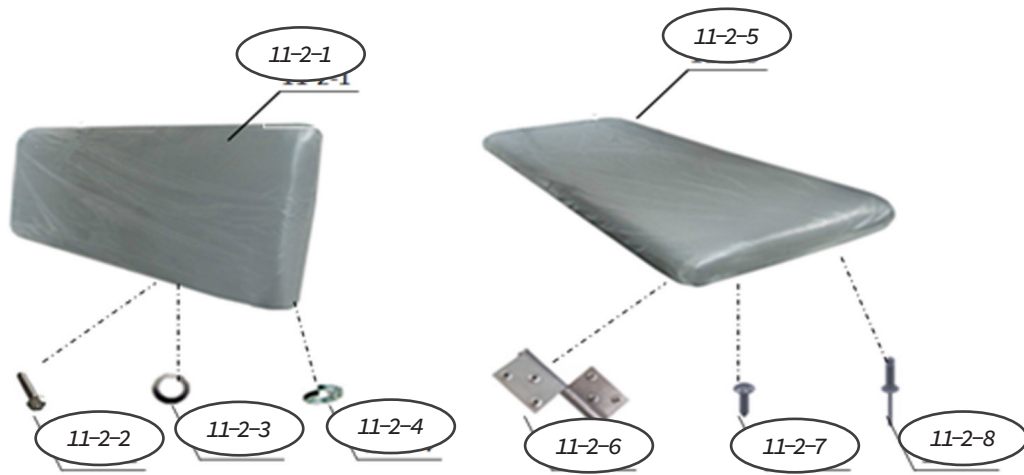

Item No.	STAR EV Part No.	Description	MPN	Qty
11-2		Middle row seats and installation accessories DN-14G-1	2101008776	2
11-2-1	2CS426	Backrest cushion assembly for 2nd or 3rd row DN.14F.1D-27000600S	3108021875	1
11-2-2		Outer hexagon bolt GB/T5783, M6*45, A2-70	2200102211000	2
11-2-3		Flat washer GB/T97.1, M6 (12*6.4*1.6), A200	2500600017000	2
11-2-4		Spring washer GB/T93,8.1	2200701092000	2
11-2-5	2CS427	Bottom cushion assembly for 2nd or 3rd row DN.14F.1D-27000400S	3108021873	1
11-2-6	2HG040	4" Hinge for seat	2202200001000	2
11-2-7		Cross recessed pan head tapping screws GB/T845 ST4.2*25, A2-70	2200500248000	6
11-2-8	2RP450	Open flat circle cap self-plugging rivet 5*20 GB/T12618 5*20 A2-70	2201000001000	6

## 13 Rear Seat

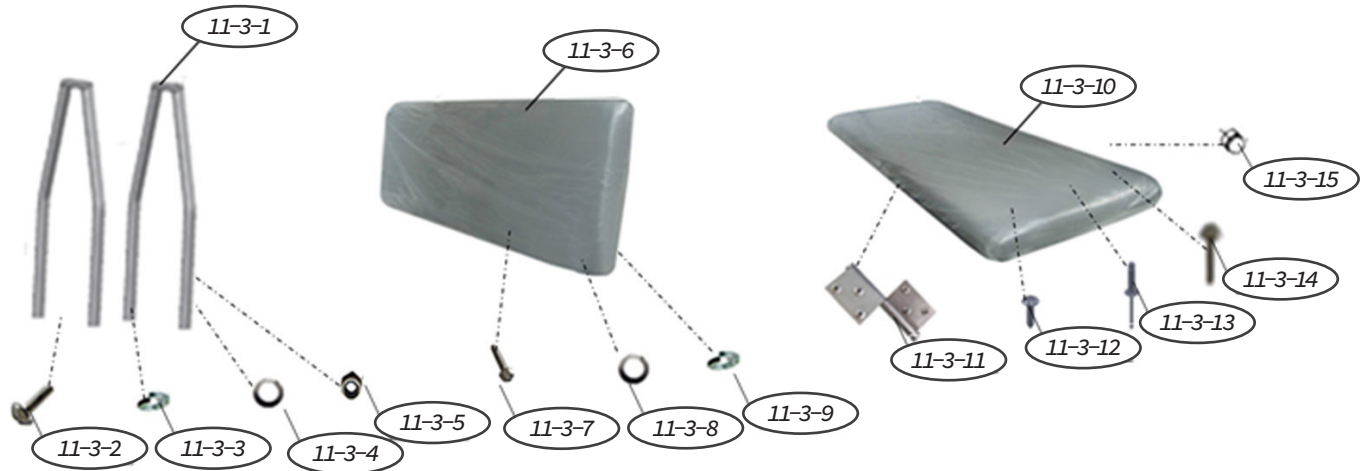

Item No.	STAR EV Part No.	Description	MPN	Qty
11-3		Rear seats and installation accessories DN-14G-1	2101008777	1
11-3-1	2CS429	Rear backrest support DN.14G.1-25010700, A1, Q235	3304001716	2
11-3-2		Hexagon socket flat round head screws GB/T 70.2 M8*45, A2-70	2200413060000	4
11-3-3		Spring washer GB/T93,8.1	2200701092000	4
11-3-4		Flat washer GB/T97.1, M8 (16*8.4*1.6), A200	2500600018000	4
11-3-5		Non metal insert hexagon lock nut GB/T889.1 M8,A2-70	2200401052000	4
11-3-6	2CS433	Backrest cushion assembly for 4th or 5th row DN.14F.1D-27000600S	3108021876	2
11-3-7		Outer hexagon bolt GB/T5783, M6*45, A2-70	2200102211000	4
11-3-8		Flat washer GB/T97.1, M6(12*6.4*1.6), A200	2500600017000	4
11-3-9		Spring washer GB/T93,8.1	2200701092000	4
11-3-10	2CS426	Backrest assembly	3108021875	2
11-3-11	2HG040	Hinge 4"	2202200001000	4
11-3-12		Cross recessed pan head tapping screws GB/T845 ST4.2*25, A2-70	2200500248000	12
11-3-13	2RP450	Open flat circle cap self-plugging rivet 5*20 GB/T12618 5*20 A2-70	2201000001000	12
11-3-14		Flat washer GB/T97.1, M6 (12*6.4*1.6), A200	2500600017000	4
11-3-15		Spring washer GB/T93,8.1	2200701092000	4

# 14 Arm Rest

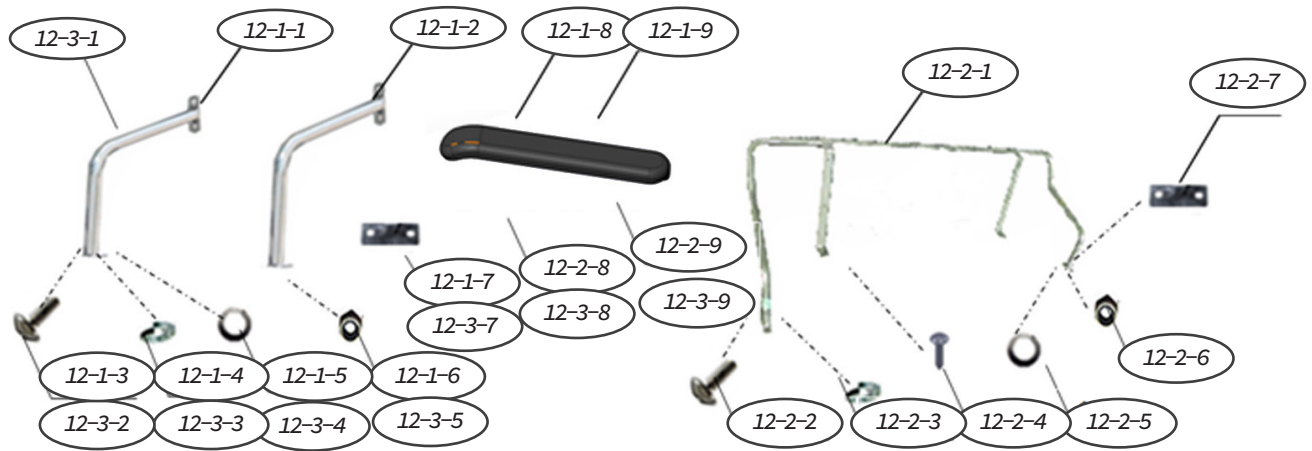

Item No.	STAR EV Part No.	Description	MPN	Qty
12-1		Armrest and installation accessories for driver's seat	2101008778	1
12-1-1	2CS422	Driver's seat armrest DN.14G-27090010S	2202600350000	2
12-1-3		Hexagon socket flat round head screws GB/T 70.2, M8*45, A2-70	2200413060000	4
12-1-4		Spring washer GB/T93,8.1	2200701092000	4
12-1-5		Flat washer GB/T97.1, M8(16*8.4*1.6), A200	2500600018000	4
12-1-6		Non metal insert hexagon lock nut GB/T889.1 M8,A2-70	2200401052000	2
12-1-7	2CS423	Armrest rubber pad DN.14F-04010303 1mm, 0.3mm	2301903097B00	4
12-2	2CS428	Middle row handrail and installation accessories DN-14G-1	2905459092000	2
12-2-1		Armrest steel frame DN.14G.1-28080010(A0)	2207202532000	1
12-2-2		Hexagon socket flat round head screws GB/T 70.2, M8*45, A2-70	2200107028000	4
12-2-3		Spring washer GB/T93,8.1	2500600018000	4
12-2-4		Cross recessed countersunk head bolt GB819-85, M8*30	2200401052000	2
12-2-5	2CS423	Flat washer GB/T97.1, M8 (16*8.4*1.6)	2301903097B00	2
12-2-6		Non metal insert hexagon lock nut GB/T889.1, M8,A2-70	2200401003000	2
12-2-7		Armrest rubber pad DN.14F-04010303 1mm, 0.3mm	2301903097B00	2
12-3		Rear armrest and installation accessories	2905459093000	2
12-3-1		Rear armrest steel frame GB/T 70.2, M8*45, A2-70	2207202533000	4
12-3-2		Hexagon socket flat round head screws	2200413060000	8
12-3-3		Spring washer GB/T93,8.1	2200701092000	8
12-3-4		Flat washer GB/T97.1, M8(16*8.4*1.6), A200	2500600018000	8
12-3-5		Non metal insert hexagon lock nut GB/T889.1, M8,A2-70	2200401052000	8
12-3-6	2CS423	Armrest rubber pad DN.14F-04010303 1mm, 0.3mm	2301903097B00	8



## 15 Body Accessories

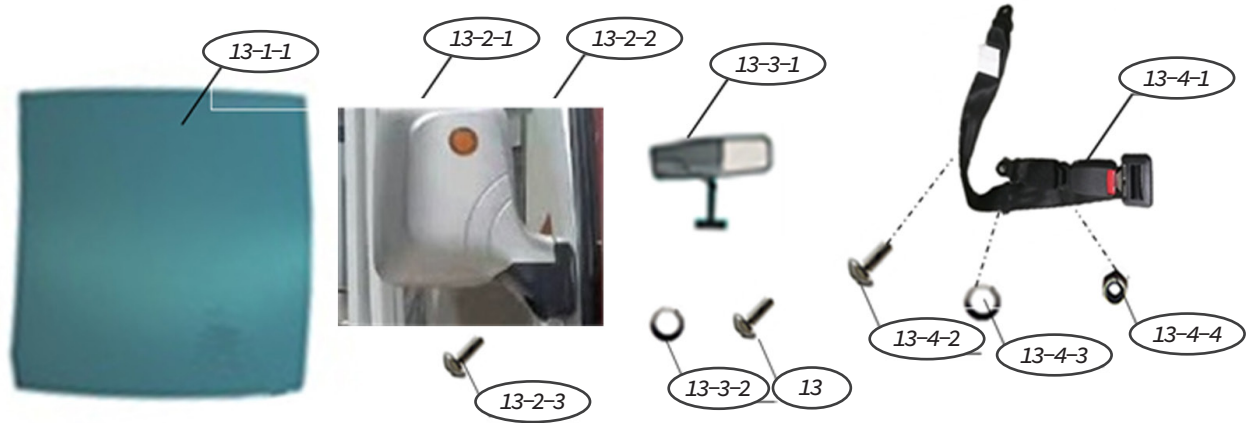

Item No.	STAR EV Part No.	Description	MPN	Qty
13		Body accessories	2905424014000	1
13-1		Windshield glass DN-14F-9	2400700496000	1
13-1-1	2WS311	Front windshield DN.14F.9-05000031 1256*1233, 3.0+0.76+3.0	2400700497000	1
13-1-2	2WD231	Left side window glass DN.11H-05000028 2.0G + 0.76+2.0G	2400700019A10	1
13-1-3	2WD241	Right window glass DN.11H-05000029 2.0G+0.76+2.0G	2400700020A10	1
13-2		Rear view mirror and installation accessories DN-14F-1G	2902701325000	1
13-2-1	2MR295	Side mirror (driver side) 234*166*72	2300407401000	1
13-2-2	2MR296	Side mirror (passenger side) 234*166*72	2300407402000	1
13-2-3		Hexagon socket flat round head screws GB/T 70.2 M8*45, A2-70	2200413060000	8
13-3	2MR400	Automobile suction cup interior mirror 200mm 60mm	2207600052000	1
13-5-1	2SB040	Safety belt	2501304017000	14
13-5-3		Seat belt anchor DN.14F.1D-05000004	2208100142A10	14
13-5-4		Hexagon socket flat round head screws GB/T 70.2M8*40, A2-70	2200301235000	28
13-5-5		Flat washer GB/T97.1, M8(16*8.4*1.6), A200	2500600018000	28
13-5-6		Non metal insert hexagon lock nut GB/T889.1M8,A2-70	2200401052000	28



Item No.	STAR EV Part No.	Description	MPN	Qty
14-1	2BD412	Middle pedal welding	3304014035	1
14-2	2BD413	Middle pedal (SIDE STEP)	3301008970	1
14-3	2BD411	Front pedal (SIDE STEP)	3301008969	1
14-4	2BD414	Rear pedal (SIDE STEP)	3301008971	1



Item No.	STAR EV Part No.	Description	MPN	Qty
15-1	2EN431	Rain curtain assembly DN.14F.9C-19010001, S/00.7MM PVC	3108041877	1
15-2	2EN432	Rain curtain assembly DN.14F.9C-19010002, S0 0.7MMPVC	3108041878	1
15-3	2EN433	Rain curtain assembly DN.14F.9C-19010003, S0, 0.7MMPVC	3108041879	1
15-4	2EN434	Rain curtain slot L = 3000mm	3406000624	1
15-5		Cross recessed pan head tapping screws GB/T845ST2.9*16, A2-70	2200500198000	10

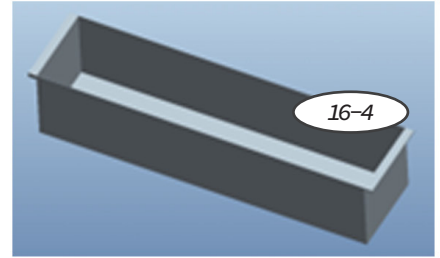
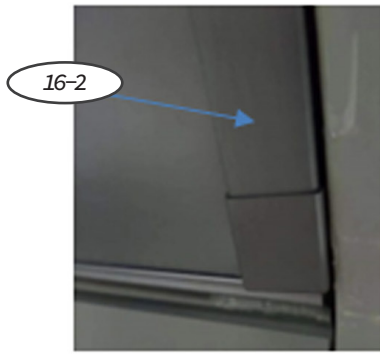

Item No.	STAR EV Part No.	Description	MPN	Qty
16-1	2RF471	Roof lining	3302008888	4
16-2	2RF472	Lining plate clamp	3315000171	4
16-3	2RF473	Interior trim panel aluminum profile	3302000136	3
16-4	2PS455	Storage box	3304011859	1
16-5	2BT407	Battery backplane	3405008994	1

# 16 Electrical Parts

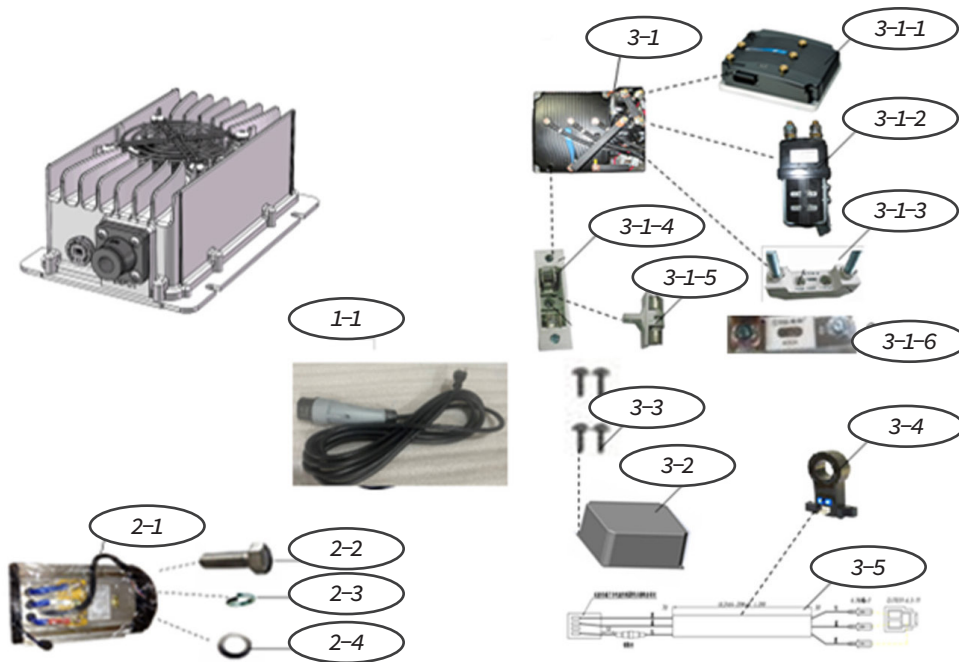

Item No.	STAR EV Part No.	Description	MPN	Qty
1		Onboard charger output 72V15A, input 110V	3202055084	1
1-1	2CR910	AC Charger Cord with Yeeda Plug 110V	2100601043000	1
2		Motor unit DN-14F-7, 72V 7.5KW	2905431002000	1
2-1	2MO350	Motor-(AC) 7.5KW-type XYQ-7.5-3AHV	2101903002000	1
2-2	3HD800	Hexagon headed bolt GB/T5783,M8*30, A2-70	2200100010000	5
2-3	3HD818	Spring washer GB/T93, m8 :316	2200701012000	5
2-4	3HD814	Flat washer GB/T97.2,m8,A200	2200700021000	5
3		Controller and installation accessories DN-14F-9C, M222-21120046	2101006401	1
3-1		Controller assembly CURTIS 72V 550A	2901501005000	1
3-1-1	2CN122	Controller; Curtis, 1238E-6521, 550A; Only AC controller	2101701016000	1
3-1-2	2SO291	Solenoid (72V) ZJW400A/ 72V (NONCHN)	2102300011000	2
3-1-3	2FU174	Fuse Holder for fuse 2FU170	1131550107000	1
3-1-4	2FU121	Fuse-Holder-10A or 20A	2303400009000	1
3-1-5	2FU150	Accessory Fuse - 10A RT14-20/10a OR (RT28-32)	2102601003000	1
3-1-6	2FU170	400A Fuse ZEEMAN-400A DC48V	2102601010000	1
3-2	2CN915	Cover for Controller	2209000020A20	1
3-3		M5 x 15 Cross recessed pan head screw GB818-85 M5*15	1205211014000	4
3-4	2MT261	Current sensor (CT module) CS500ET2 10.5-13.5VDC, 0-5V, 1VDC/100A, 600A	2102700013000	1
3-5	2MT262	Wire connector for Current Sensor DN.14F-14030001	2901711079B00	1



Item No.	STAR EV Part No.	Description	MPN	Qty
4		Accelerator and installation accessories DN-11F-9	2905433015000	1
4-1	2AC301	Accelerator 12,95V,4.65V, IP67	2102000038000	1
4-2		Outer hexagon bolt GB/T5783 - M6 x 25, A2-70	2200102173000	2
4-3		Non metal insert hexagon lock nut GB/T889.1-M6,8	2200401054000	2
4-4		M6 washer GB/T97.1, M6(12*6.4*1.6) A200	2500600017000	2
5		Electronic lock and mounting accessories DN-14F-1G	2902701339000	1
5-1	2SW290	Unique Ignition switch with key	2101500006000	1
5-2	2DC106	Electronic lock cover plate DN.14F-01020302	2207300075B10	1
5-3		M6 x 16 Cross recessed pan head screw GB/T973 M6*16	2200500020000	4
6		Electrical harness device DN-14F 9C, (XSE12201070008)	2101007267	1
6-1	2BT134	Battery connection cable DN.14F.9-14210204S	2100400682000	1
6-2	2BT133	Positive and negative power lines of controller DN.14F.9-14210205S	2200025244S00	1
6-3	2BT132	Motor connecting wire DN.14F.9-14000004(A0)	2901712131000	1
6-4	2WH303	Power control harness DN.14G-14200701S	2200022425S00	1
6-5	2WH313	Lighting harness DN.14F.9A-14000007(A0)	2901704231000	1
6-5-1	2FU320	Chip type (automobile fuse) 15A/32V 19*19*5mm	2102600027000	4
6-5-2	2FU300	Chip type (automobile fuse) 25A/32V 19*19*5mm	2102600006000	2
7		Converter device and installation accessories DN-14F-1G	2902701341000	1
7-1	2CV152	DC converterfor Lighting ip DCNI-7212-30 72V 12V 30A	2101800020000	1
7-2		Cross recessed pan head screws GB818-85 M5*12	2200304008000	4
7-3		Spring washer GB/T 93 5	2200701008000	4
7-4		Flat washer GB/T97.1 5	2200700009000	4
8		Light fixtures and mounting accessories DN-11F-9	2905437039000	1

8-1		Headlights DN.14F-14002021	2100700305000	2
8-2		Outer hexagon bolt GB/T5783-M8 x 20,A2-70	2200102135000	4
8-3		M8 LARGE WASHER GB/T96, M8 (24*8.4*2, A200	2200704006000	4
8-5	2LT313	FRONT TURN light Φ80 LED-orange	6100902004000	2
8-6	2LT312	Front FOG Light Φ80 LED-clear	6100902006000	2
8-7	2LT314	REAR TURN LIGHT 12V LED φ 95*50 (orange)	2100700464000	2
8-8	2LT309	REAR BACKUP LIGHT (clear) 12V LED φ95*50	2100700465000	2
8-9	2LT324	Taillight 12V LED φ95*50 -RED	2100700463000	2
9		Instrumentation and installation accessories DN-14G-1	2905438062000	1
9-1	2MT282	Instrument panel / Digital Display DN.14G.1-14000012	2100200138000	1
9-2		Cross recessed pan head tapping screws GB/T845-ST2.9 x 13, A2-70	2200500008000	5
9-3	2MT284	Camera	2100313026000	1
9-4		M2 x 25 Cross recessed countersunk head self drilling self tapping screw GB/T15856.2 ST4.2 x 25	2200300068000	2
10		Combined switchgear DN-14G	2905439009000	1
10-1	2SW381	Combination switch JK306H	2101400183000	1
10-2		Cross recessed pan head screws GB/T818 M5*20	2200304005000	2

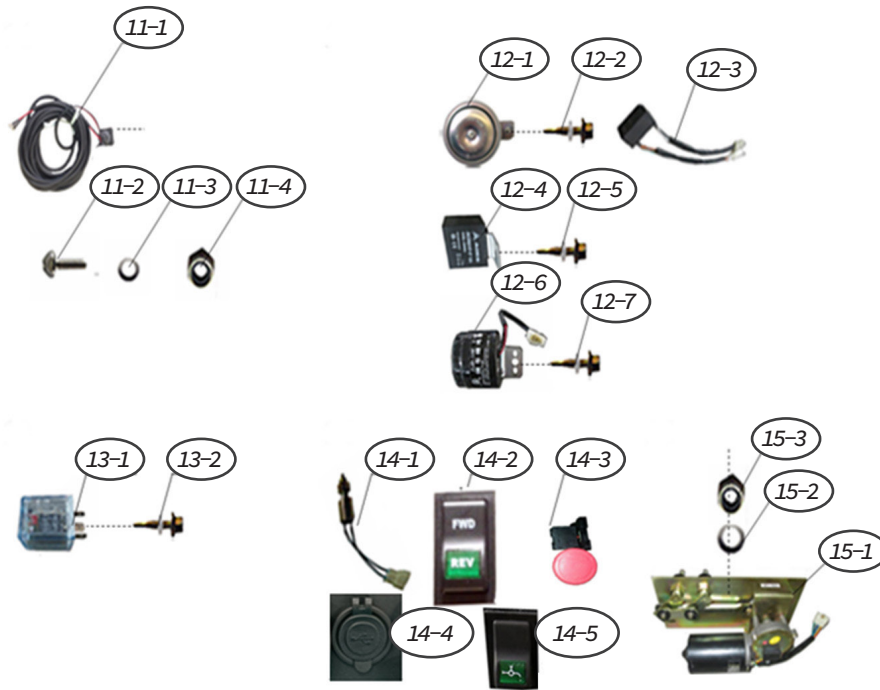

Item No.	STAR EV Part No.	Description	MPN	Qty
11		Charging base device and installation accessories		1
11-1		Charging port	2100601042000	1
11-2		M6 x 20 Cross recessed pan head screw GB/T973, M6*20, A2-70	2200305003000	4
11-3		M6 304SS Flat washer GB/T97.1 6	2200700088000	4
11-4		M6, A2-70 Hexagon lock nut with non-metallic insert stainless steel	2200401001000	4
12		Horn device and installation accessories	2902705606000	1
12-1	2SW210	Electric horn DC12V3A, 105dB	2101600001000	1
12-2		M5*20 External hexagon rear end self drilling screw	2200307005000	1
12-3	2CV130	Power module assembly DN.14.1C-14002009	2902900005C00	1
12-4	2RL050	Relay 72V20A DC12V	2102602004000	1
12-5		M5*20 External hexagon rear end self drilling screw	2200307005000	1
12-6	2SW340	Reversing buzzer	2101602011000	1
12-7		M5*20 External hexagon rear end self drilling screw	2200307005000	1
13		Flasher unit and mounting accessories DN-14F-1G	2902701347000	1
13-1	2RL060	Flasher SG152B DC12V/130W, 90±30	2101603003000	1
13-2		Hexagonal rear end self drilling screw M5*20	2200307005000	1
14		Switch accessories DN-14F-9C, M222-21120046	2101006410	1
14-1	2SW540	Brake light switch 1mm DC12V10A(6M)	2101400002000	1
14-2	2SW430	Gear switch (English) FWD /REV	2101400046000	1
14-3	2SW191	Emergency stop switch LA38/203	6101100019000	1
14-4	2SW702	DOUBLE USB car charger 5V 2.1A DC6-30V U5106 USB 6-30VDC5V	2020610031000	1
14-5	2SW301	Water spray switch 12V6A	2101400006000	1
15	2WP078	Wiper device and installation accessories DN-14F-9C, M222-21120046	2101006406	1

15-1		Wiper (including motor) 1.0, 800, 620, DN-14FZD1050, 2.2M	2100500016000	1
15-2		Flat washer GB/T97.2-8	2200700180000	3
15-3		Non metal insert hexagon lock nut GB/T889.1-M8	2200404058000	3



## 17 Optional Parts

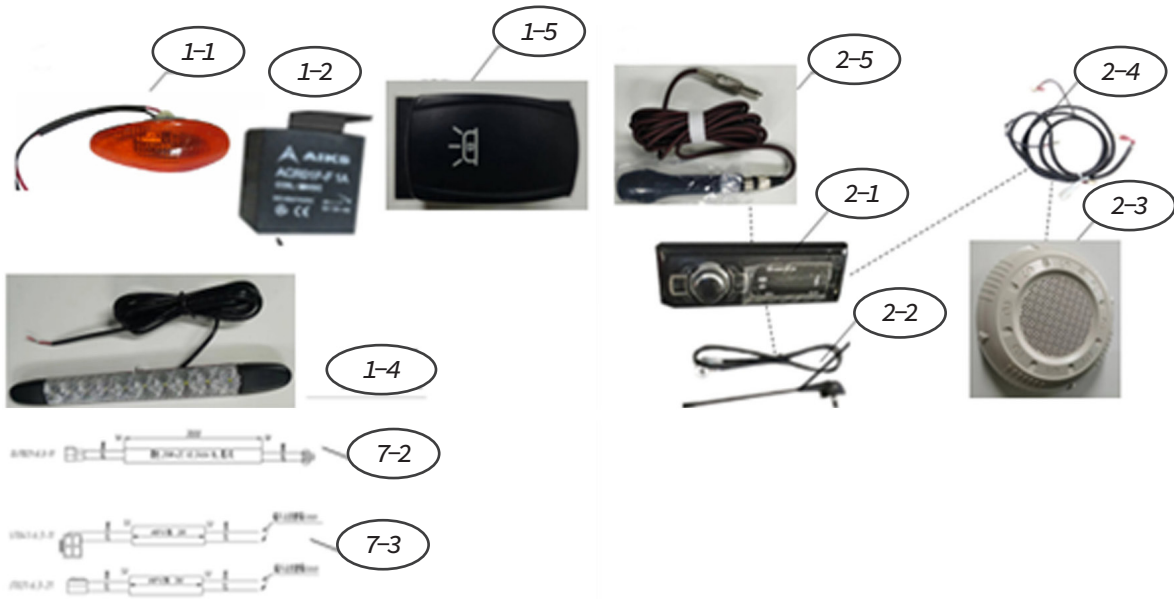

Item No.	STAR EV Part No.	Description	MPN	Qty
1-1	2LT323	Side turn signal lamp assembly	2901800022B00	8
1-2	2RL050	Relay 40A DC72V	2102602003000	2
1-4	2LT316	Top roof light 12VLED S3 E9-02.169, DOT	2100700212000	3
1-5	2SW316	Top light switch of passenger compartment	2101400188000	2
2	2RD601	DVD Player Assembly 12VDVD DDN.8-14001027	2100300007B00	1
2-1	2RD602	DVD player JL9011 MP5,12V	2100300022000	1
2-2	2RD603	Antenna CD, YJH-419	2100304005000	1
2-3	2RD055	Integrated electric horn DN.14F-14010029	2101600021000	4
2-4	2RD608	CD player outlet assembly DN.14F-1400102914FCD	2901717003A00	1
2-5	2RD180	Microphone 6.3 FM-600 M-01MH-01	2100306001000	1
7-2	2RD610	DVD memory power cable DN.23B-14010103S, S0 DVD	2200024511S00	1
7-3	2RD611	Connecting line (power supply) DN.14F.3-14220303S, S0	3205024389	1